

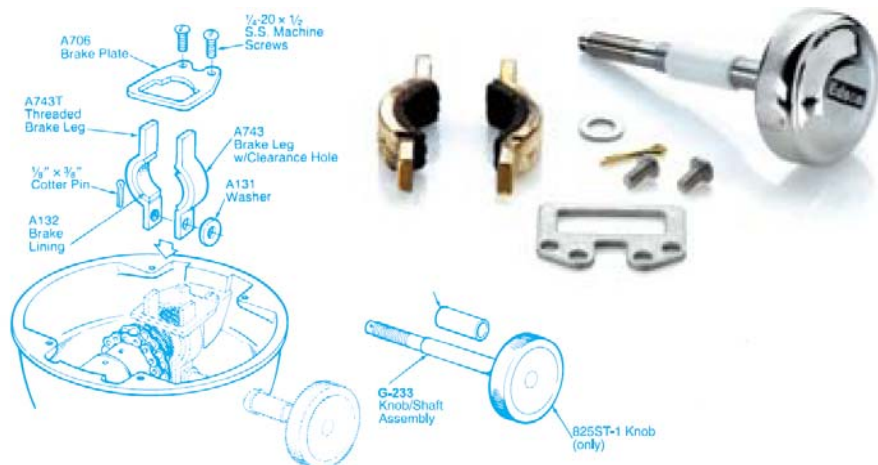

Edson Side Mount Wheel Brake Installation and Brake Leg Replacement Guide

For All 689 and 783 Wheel Brakes



Brake Parts List

Part #	Qty.	Description
316-689 Brake maintenance Kit includes		
960-A-743T	1	Threaded Brake Leg
960-A-743	1	Brake Leg w/Clearance Hole
969-A-131	1	Washer
F1/8-3/4BR-CP	1	Brass Cotter Pin
960-A-125	1	Delrin Bushing
689ST-689 Side Mount Brake also includes		
960-G-233	1	Knob/Shaft Assembly
960-A-706	1	Brake Plate
F1/4-1/2RHP	2	Round Head Machine Screws
738ST-8 Shaft mount brake also includes		
960-A-844	1	Brake Bracket
960-A-693	1	Brake Collar

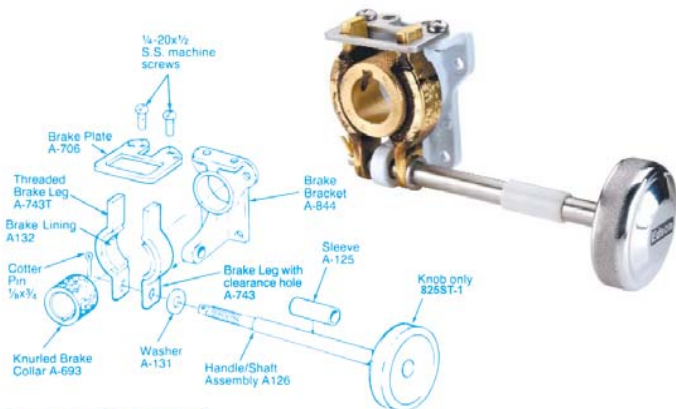
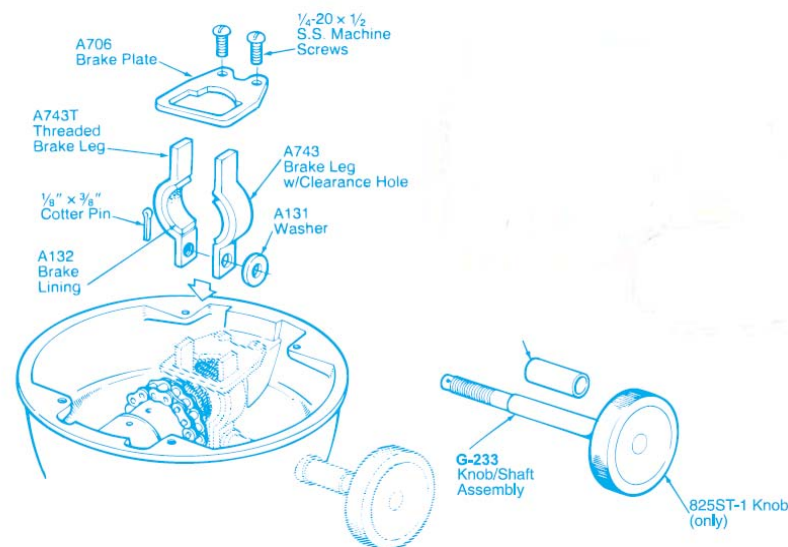

New Brake Installation

1. Remove black plastic plug in starboard side of pedestal if installed.
2. Press A125 Sleeve into hole, leaving approximately 1/4" exposed.
3. Insert A126 Knob/Shaft Assy. through sleeve.
3. Guide shaft through A131 Washer on the inside of the pedestal.
4. Insert shaft through A743 Brake Leg on the starboard side of the sprocket.
5. Hold A743T Threaded Leg on port side of sprocket and thread Brake Shaft into threads.
6. Install A706 Brake Plate over the ends of the Brake Legs and secure with 1/4-20 Screws. Test for proper operation and clamping action.

If brake does not clamp properly, check that washer has been installed between shaft shoulder and A743 starboard brake leg.

7. Install new cotter pin through the end of the Brake Shaft and bend slightly.

IMPORTANT: Cotter Pin should be installed only after the operation and clamping action of the brake has proven to be satisfactory. A131 Washer must be installed between shaft shoulder and A743 Brake Leg for proper braking action. Cotter pin must be installed to secure brake shaft.

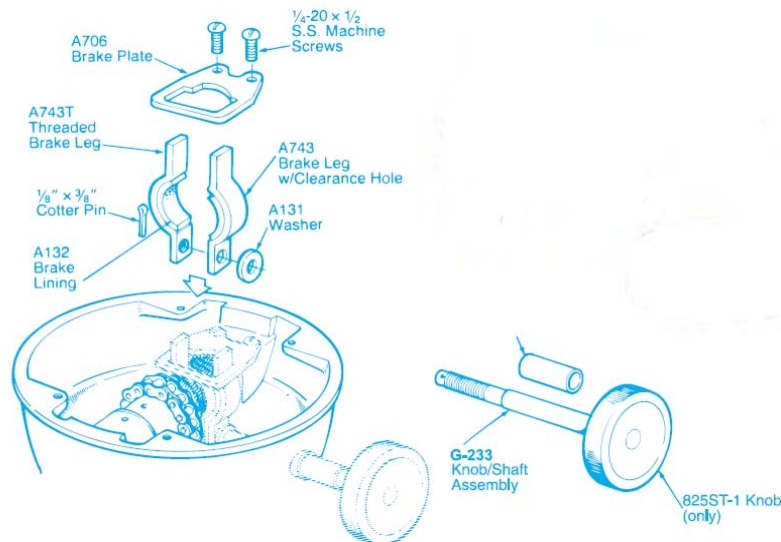

Brake Leg Replacement

After years of use, especially if the brake is often engaged while in use, the brake pads may wear out, or some grease may have accumulated on the pads and knurling. When the brakes effectiveness is greatly reduced from new, the brake pads should be replaced. You can purchase Edson's Brake Maintenance Kit (Part#316-689), which includes all of the materials needed to re-line and renew your Pedestal Brake.

Brake Removal

1. Stuff a rag down the pedestal tube so that any dropped parts can be easily retrieved.
2. Using a long screwdriver, straighten out cotter pin on Brake Shaft end and remove with a long needle nosed pliers (don't worry about saving it, a new one is provided).
3. Remove the two 1/4-20 screws securing A706 Brake Plate. Remove Brake Plate.
4. Holding A743T Threaded Brake Leg (Port) in your left hand, unscrew (counterclockwise) A91 Brake Knob. When Shaft threads are clear of threaded leg, lift out Threaded Leg and set aside.
5. Holding A743 Brake Leg (Starboard) in your left hand, pull the A126 Knob/Shaft Assy. out of the Brake Leg and set Brake Leg aside. **(Be careful that the A131 Washer does not fall off of the shaft).** Carefully remove the washer from the shaft and remove the shaft from the pedestal.
6. Reinstall brake components as described in installation instructions and check operation before installing cotter pin.
7. If brake does not clamp properly, check that washer has been installed between shaft shoulder and A743 starboard brake leg.