

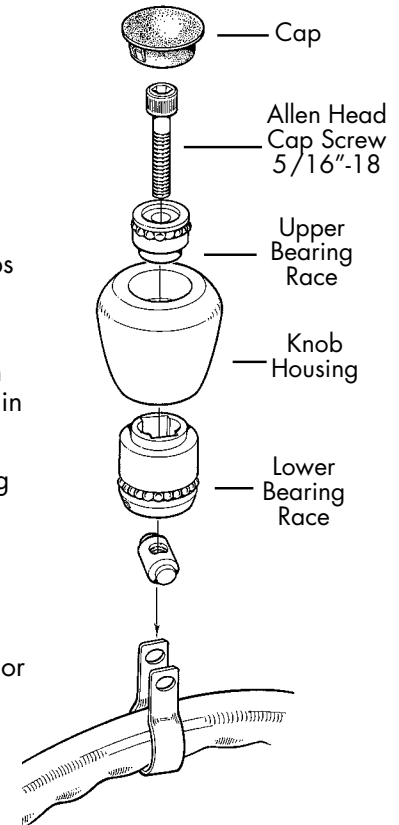

EDSON POWERKNOB INSTALLATION INSTRUCTIONS

Strap-On Instructions

1. Using a screw driver with a thin blade, remove the Cap from the top of the Power Knob™ and use the provided allen wrench to remove the Allen Head Cap Screw from the center of the Power Knob.
2. Remove the Upper and Lower Bearing Races from the Knob Housing.
3. Remove the Straps and Barrel Nut from the Lower Bearing Race and place the proper size Strap around your wheel Rim. NOTE: You may need to try both Straps to get a tight fit. The small Strap fits rims up to one inch. The larger Strap fits rims larger than one inch.
4. Once the proper Strap is around the rim, put the Barrel Nut back in the holes on the Strap and insert them back into the Lower Race Housing making sure the hole in the Barrel Nut is facing up.
5. Place the Knob Housing over the Lower Bearing Race and put the Upper Bearing Race back inside the Knob Housing.
6. Insert the Allen Head Cap Screw back through the top and tighten a couple of turns.
7. Make sure the Power Knob is positioned properly for the operators use and tighten the Allen Head Cap Screw. Make sure not to over tighten on wood, plastic or foam covered wheel rims.
8. Replace Cap.



Bolt-On Instructions (For solids wheel rims only)

Instead of strapping the knob onto the wheel rim, an alternative method of attachment is to bolt the knob directly to the wheel rim.

1. Remove the Straps, Barrel Nut and installed Cap Screw from the Knob.
2. Insert the longer 2" Allen Head Cap Screw through the top of the Upper Bearing Race, Knob Housing and Lower Bearing Race.
3. Drill 1/4" hole in wheel rim at desired location and tap with a 5/16-18 tap.
4. Tighten Knob with Allen Head Screw securely and replace Stainless Cap.

IMPORTANT: This method is to be used on solid wheel rims only.

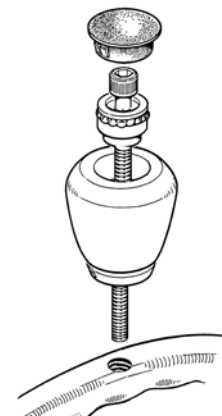

WARNING - Edson Powerknobs are for use on watercraft and off road vehicles only!